



A96 90° single clapper two way inlets

Standard equipment

Cast brass two-way inlet body with single swing clapper and pin or rocher lug hose thread swivel; angle NPT outlet connection.

Product

An exposed auxiliary inlet connection with 500 G.P.M. inlet capacity to supplement fire protection water supply. Exposed design provides an economical method of satisfying Fire Dept. inlet requirement

Branding

AUTO SPKR

Optional finishes:

RP - Red painted

a	b
4"	2 1/2"

Thread

A96Y000	SIAM 4" X 2 1/2" without swivel
A96Y001	SIAM .4" X 2 1/2" NST PL
A96Y003	SIAM. 4" X 2 1/2" CSA RL
A96Y004	SIAM 4" X 2 1/2" BCT RL
A96Y005	SIAM. 4" X 2 1/2" QST RL
A96Y006	SIAM. 4" X 2 1/2" WCT RL
A96Y007	SIAM. 4" X 2 1/2" NSST RL
A96Y008	SIAM .4" X 2 1/2" NWFLD RL

Available also with red painted body

A96Y053	SIAM. 4" X 2 1/2" CSA RL Red
A96Y054	SIAM. 4" X 2 1/2" BCT RL Red
A96Y055	SIAM. 4" X 2 1/2" QST RL Red
A96Y056	SIAM. 4" X 2 1/2" WCT RL Red
A96Y057	SIAM 4" X 2 1/2" NSST RL Red
A96Y058	SIAM. 4" X 2 1/2" NWFD RL Red

Construction

Cast brass two-way inlet body with single clapper and pin or rocker lug hose thread swivel.

Dimensions

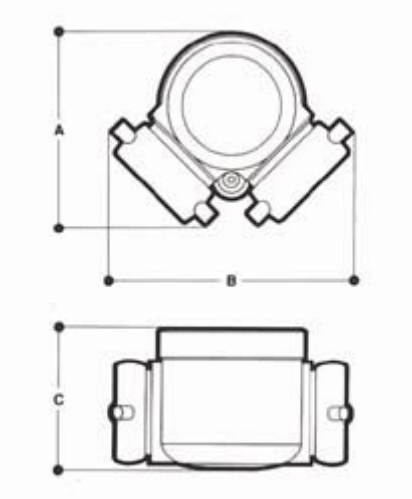

	4" x 2 1/2"
A	8 5/64"
B	6 11/16"
C	4 29/32"

Function

Used as an auxiliary inlet connection providing 500 gpm minimum to supplement the fire protection water supply (NFPA 14 Section 5.9 and NFPA 13 Section 2.7). Swing clapper provides unobstructed waterway. Exposed design is an economical method of satisfying Fire Dept. inlet requirements.
